

Rock Anchor METEORA - Stainless Steel AISI 316L  
 Χημικό Αγκύριο Ασφάλισης - Ανοξείδωτο Ατσάλι AISI 316L

user's manual / εγχειρίδιο χρήσης

**certificates πιστοποιήσεις** EN 959:2018  
**UIAA 123\_3**

**suitable for κατάλληλο για**

- outdoor
- caving
- rope access
- canyoning

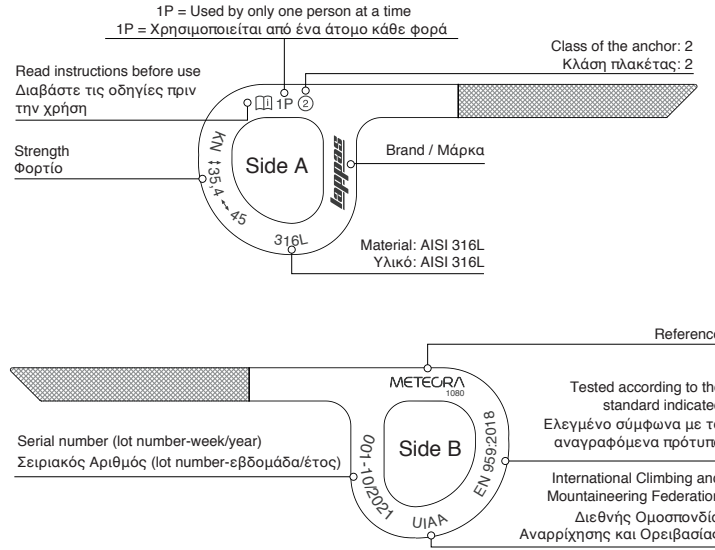
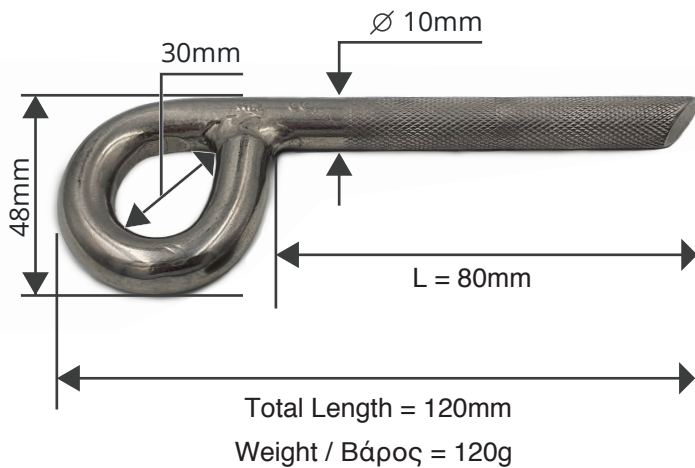

**resistance requirements - static tests**  
**απαιτήσεις στατικής φόρτισης**

A	EN 959:2018	25kN
	UIAA 123_3	25kN
B	EN 959:2018	15kN
	UIAA 123_3	20kN

**effective strength / μέγιστη φόρτιση**

A	45kN	B	35,4kN
---	------	---	--------

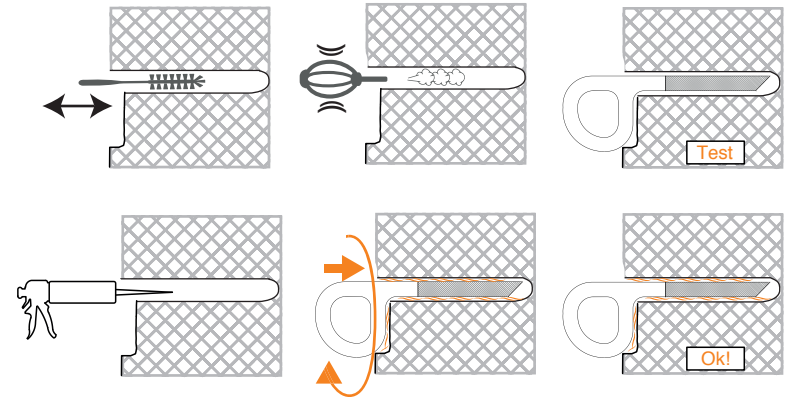
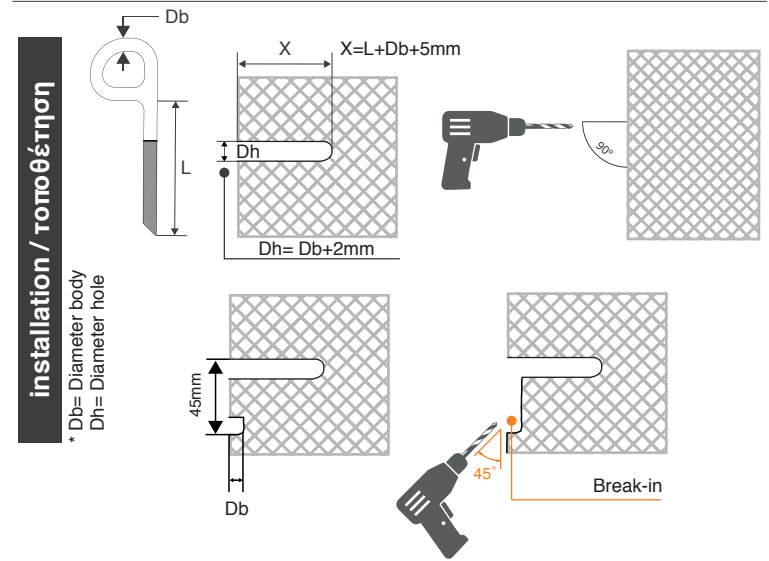

**APPROVED USE / ΟΡΘΗ ΧΡΗΣΗ**

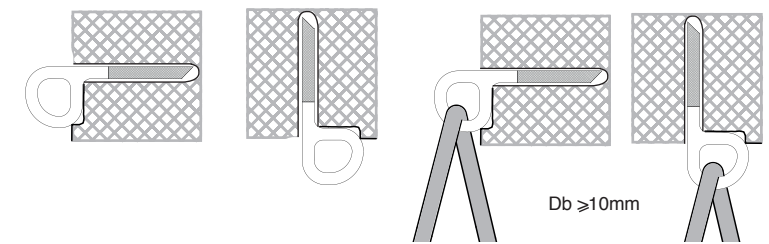

**WARNING / ΠΡΟΣΟΧΗ**

**RISK OF ACCIDENT / ΚΙΝΔΥΝΟΣ ΑΤΥΧΗΜΑΤΟΣ**

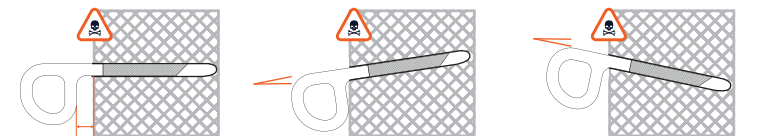

After the resin, do not touch the anchor and use it placed no earlier than 24 hours, even better if not least after 2/3 days (dependent on ambient temperature...).

Still comply with the direction set by the factory of the resin used.

The use of polyester type glue shall not be recommended.

Rock Anchor METEORA - Stainless Steel AISI 316L  
 Χημικό Αγκύριο Ασφάλισης - Ανοξείδωτο Ατσάλι AISI 316L

user's manual / εγχειρίδιο χρήσης

**certificates πιστοποιήσεις** EN 959:2018  
**UIAA 123\_3**

**suitable for κατάλληλο για**

- outdoor
- caving
- rope access
- canyoning

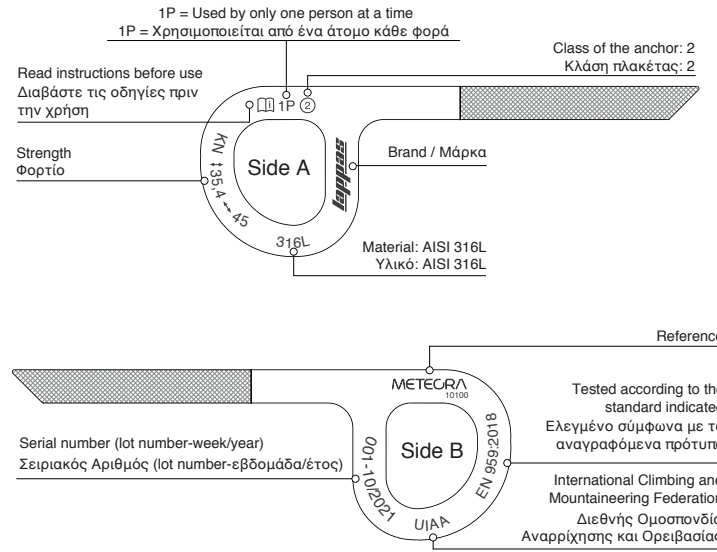
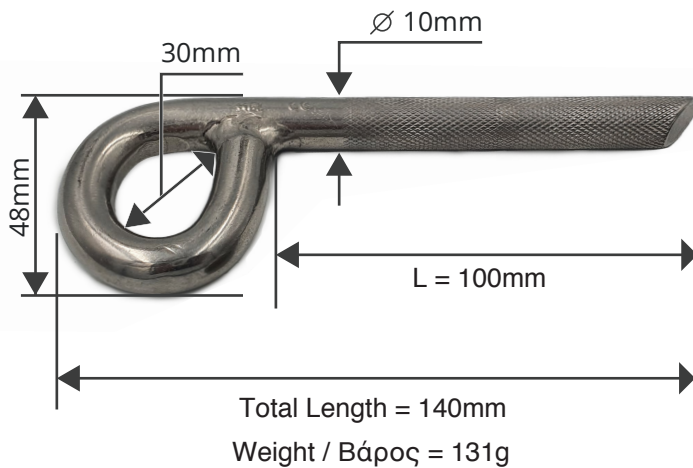

**resistance requirements - static tests**  
**απαιτήσεις στατικής φόρτισης**

<b>A</b>	EN 959:2018	25kN
	UIAA 123_3	25kN
<b>B</b>	EN 959:2018	15kN
	UIAA 123_3	20kN

**effective strength / μέγιστη φόρτιση**

<b>A</b>	45kN
<b>B</b>	35,4kN

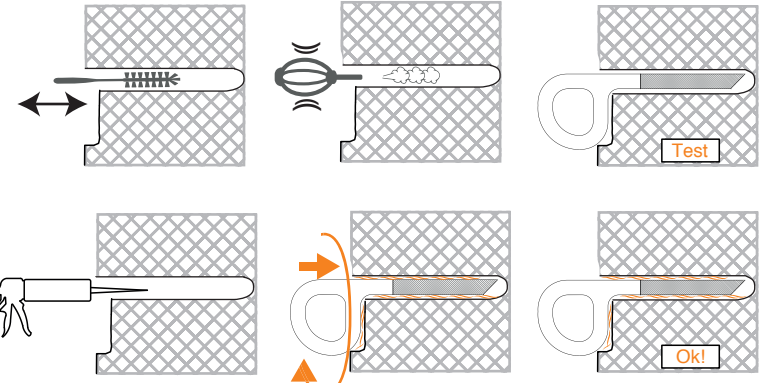
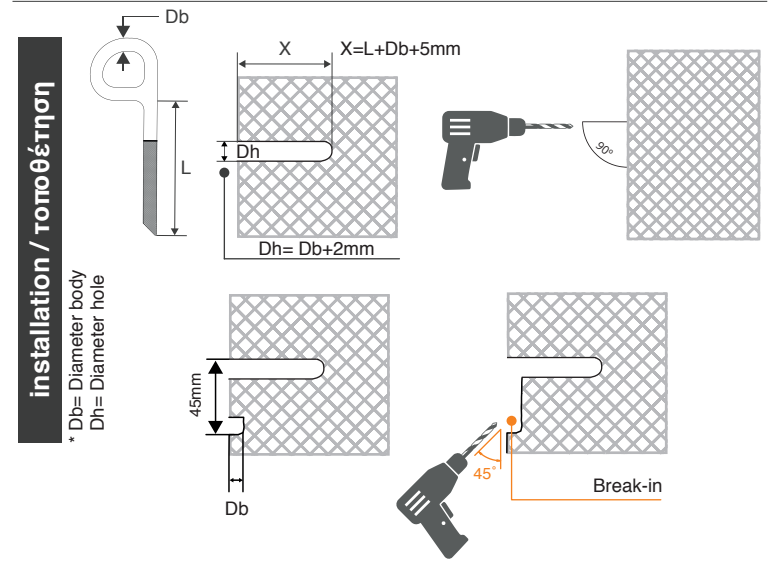

**APPROVED USE / ΟΡΘΗ ΧΡΗΣΗ**

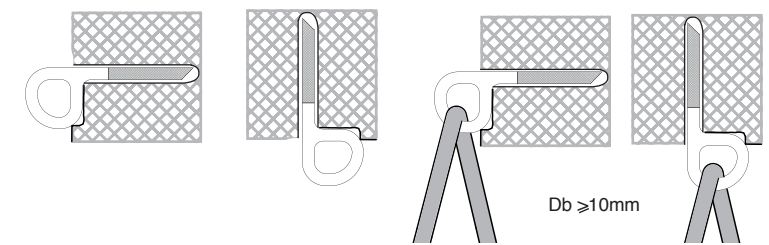

**WARNING / ΠΡΟΣΟΧΗ**



After the resin, do not touch the anchor and use it placed no earlier than 24 hours, even better if not least after 2/3 days (dependent on ambient temperature...).

Still comply with the direction set by the factory of the resin used.

The use of polyester type glue shall not be recommended.

Rock Anchor METEORA - Stainless Steel AISI 316L  
Χημικό Αγκύριο Ασφάλισης - Ανοξείδωτο Ατσάλι AISI 316L

user's manual / εγχειρίδιο χρήσης

**certificates πιστοποιήσεις** EN 959:2018  
 **UIAA 123\_3**

**suitable for κατάλληλο για**

- outdoor
- caving
- rope access
- canvoning

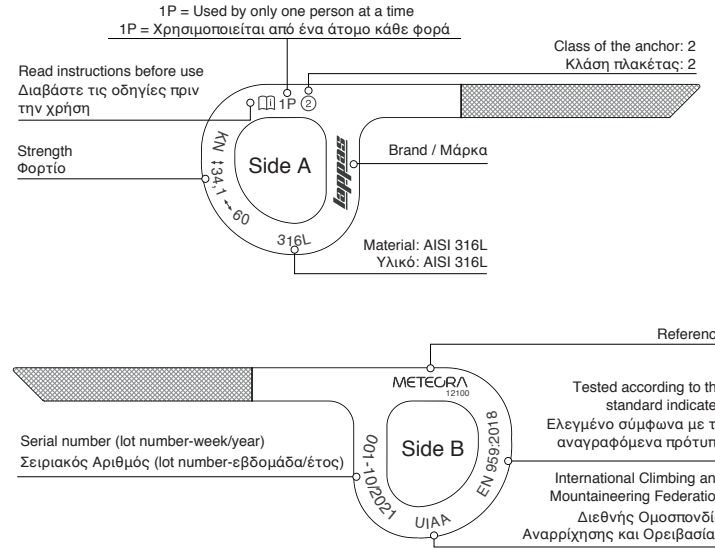
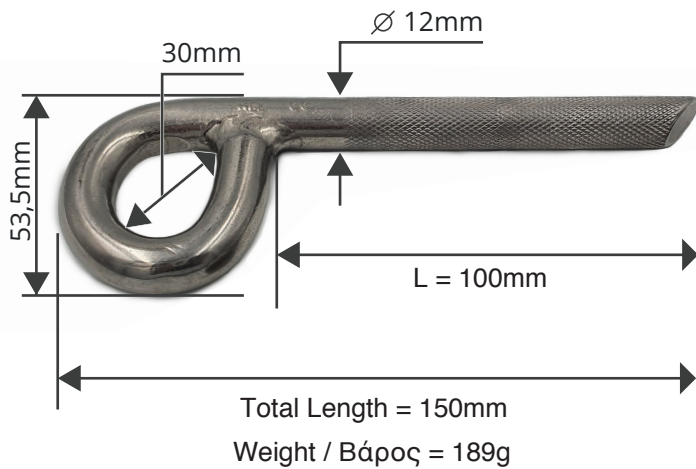

**resistance requirements - statics tests**  
**απαιτήσεις στατικής φόρτισης**

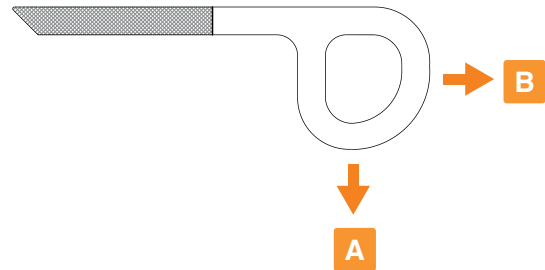

<b>A</b>	EN 959:2018	25kN
	UIAA 123_3	25kN
<b>B</b>	EN 959:2018	15kN
	UIAA 123_3	20kN

**effective strength / μέγιστη φόρτιση**

<b>A</b>	60kN	<b>B</b>	34,1kN
----------	------	----------	--------

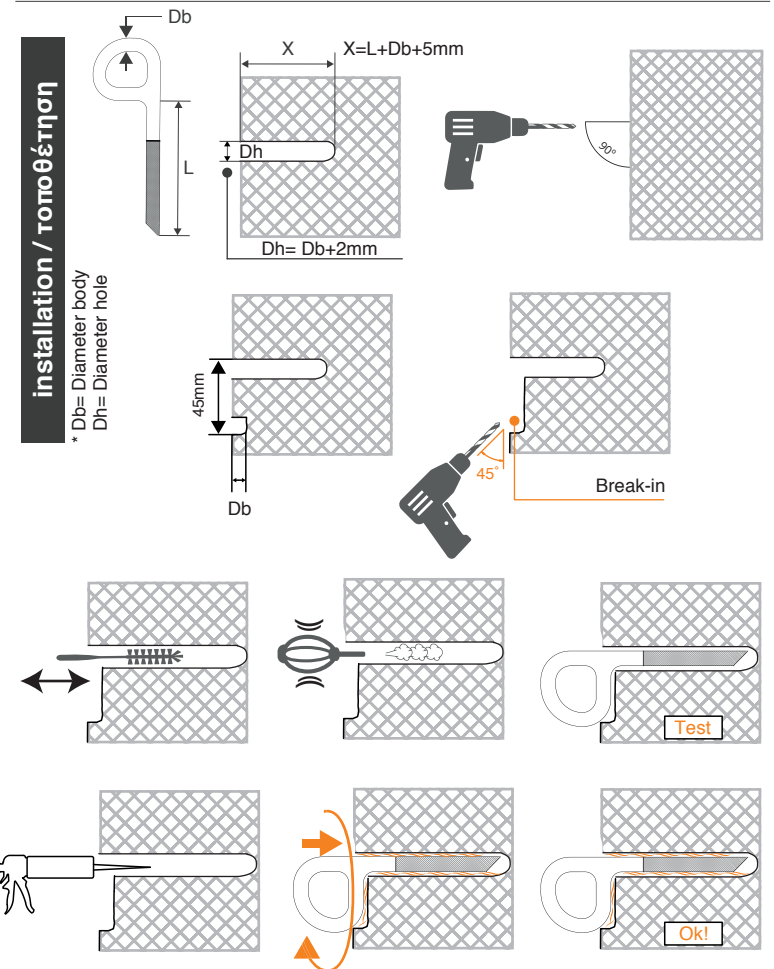

**APPROVED USE / ΟΡΘΗ ΧΡΗΣΗ**

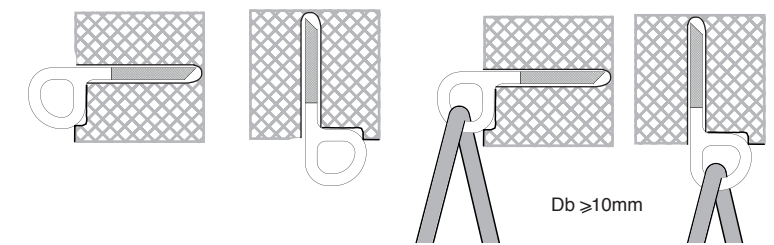

**WARNING / ΠΡΟΣΟΧΗ**



After the resin, do not touch the anchor and use it placed no earlier than 24 hours, even better if not least after 2/3 days (dependent on ambient temperature...).

Still comply with the direction set by the factory of the resin used.

The use of polyester type glue shall not be recommended.

Rock Anchor METEORA+ - Stainless Steel AISI 316L  
Χημικό Αγκύριο Ασφάλισης - Ανοξείδωτο Ατσάλι AISI 316L

user's manual / εγχειρίδιο χρήσης

certificates  
πιστοποιήσεις

EN 959:2018  
UIAA123\_3

suitable for  
κατάλληλο για

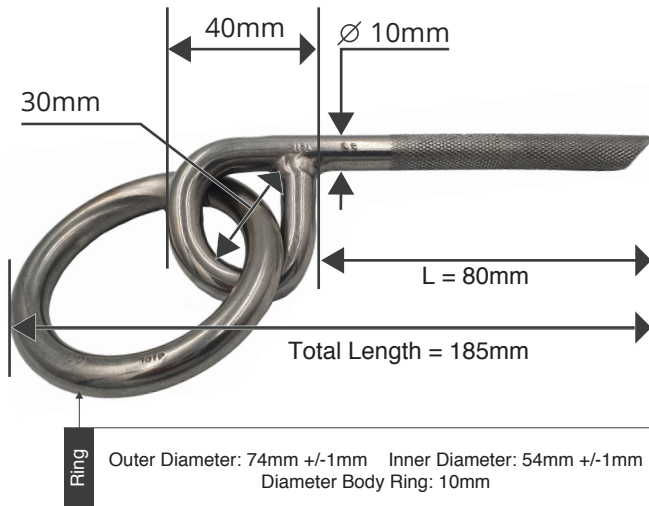

Weight / Βάρος = 230g

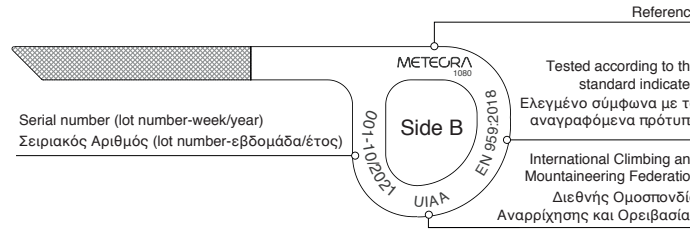
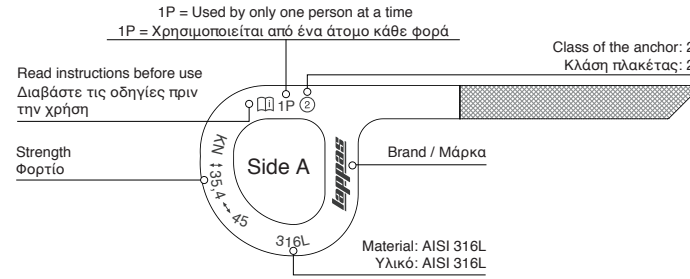

### resistance requirements - statics tests

### απαιτήσεις στατικής φόρτισης

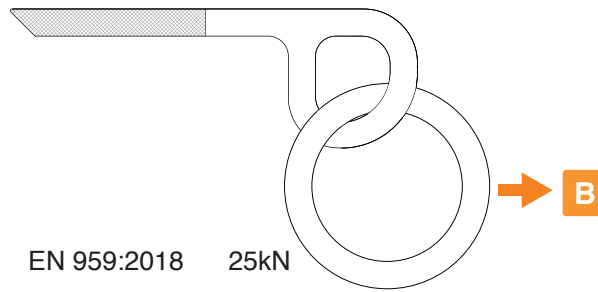

A	EN 959:2018	25kN
	UIAA 123_3	25kN
B	EN 959:2018	15kN
	UIAA 123_3	20kN

### effective strength / μέγιστη φόρτιση

A	45kN	B	35,4kN
---	------	---	--------

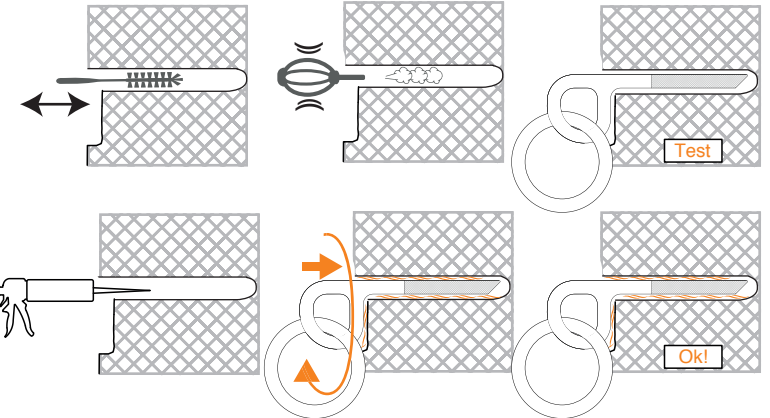
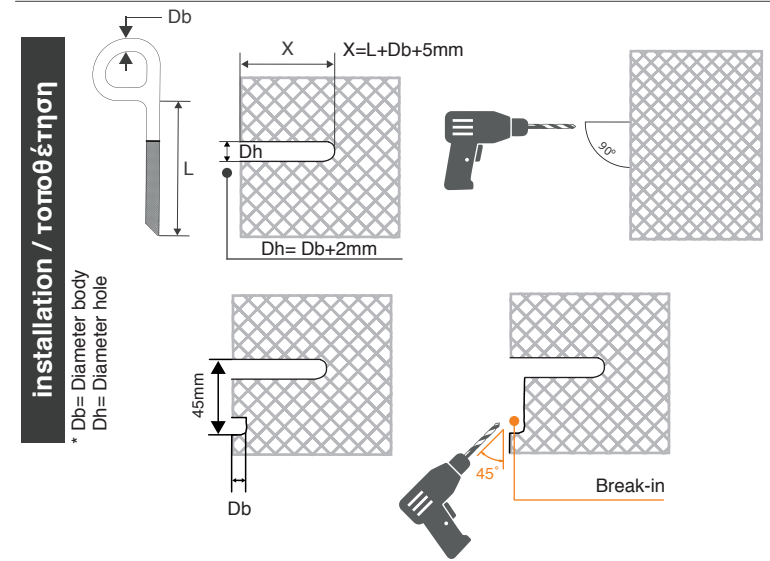

### APPROVED USE / ΟΡΘΗ ΧΡΗΣΗ

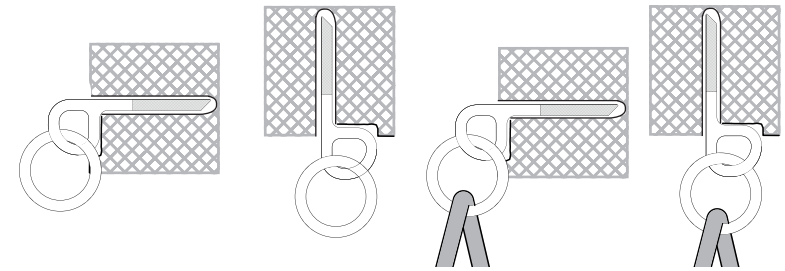

### WARNING / ΠΡΟΣΟΧΗ

### RISK OF ACCIDENT / ΚΙΝΔΥΝΟΣ ΑΤΥΧΗΜΑΤΟΣ

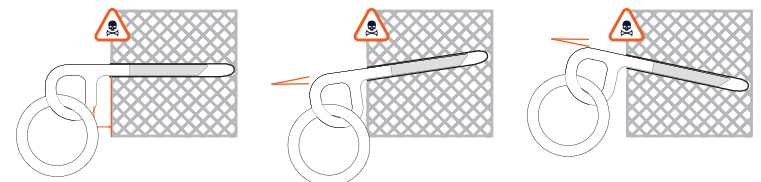

After the resin, do not touch the anchor and use it placed no earlier than 24 hours, even better if not least after 2/3 days (dependent on ambient temperature...). Still comply with the direction set by the factory of the resin used. The use of polyester type glue shall not be recommended.

Rock Anchor METEORA+ - Stainless Steel AISI 316L  
Χημικό Αγκύριο Ασφάλισης - Ανοξειδωτο Ατσάλι AISI 316L

user's manual / εγχειρίδιο χρήσης

certificates  
πιστοποιήσεις

EN 959:2018  
UIAA123\_3

suitable for  
κατάλληλο για

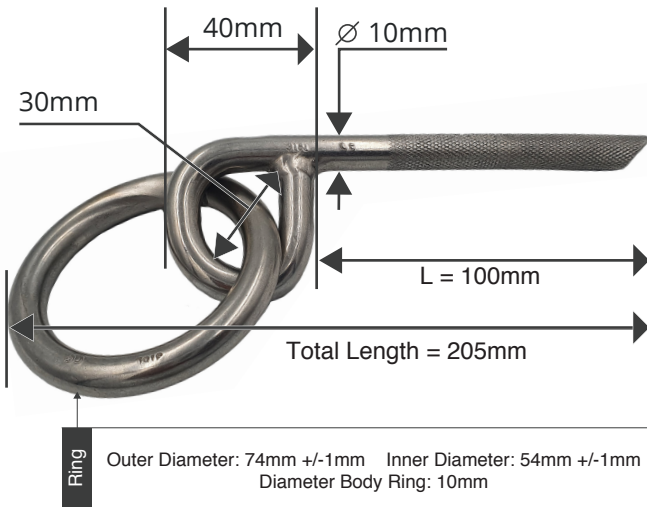

Weight / Βάρος = 257g

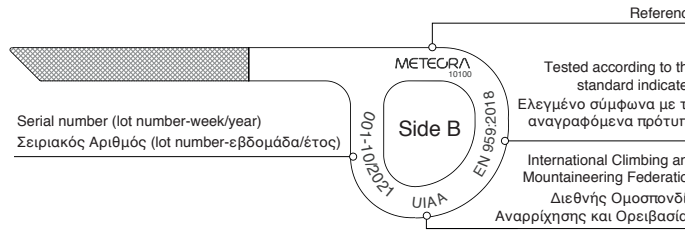
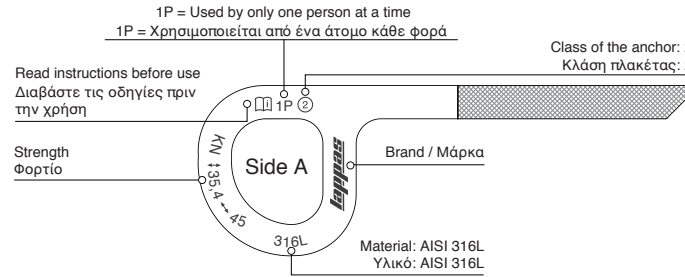

### resistance requirements - statics tests απαιτήσεις στατικής φόρτισης

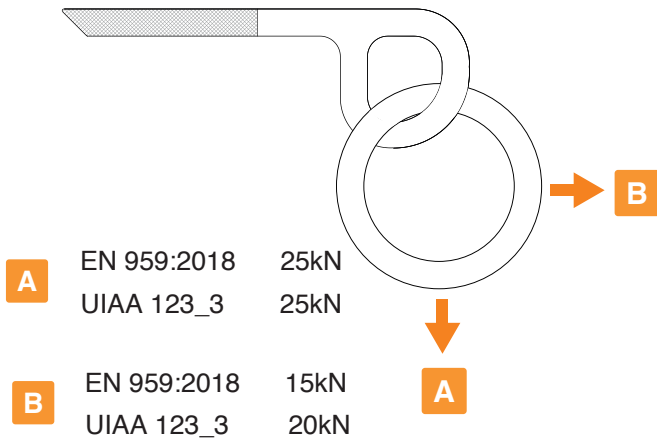

### effective strength / μέγιστη φόρτιση

**A** 45kN      **B** 35,4kN

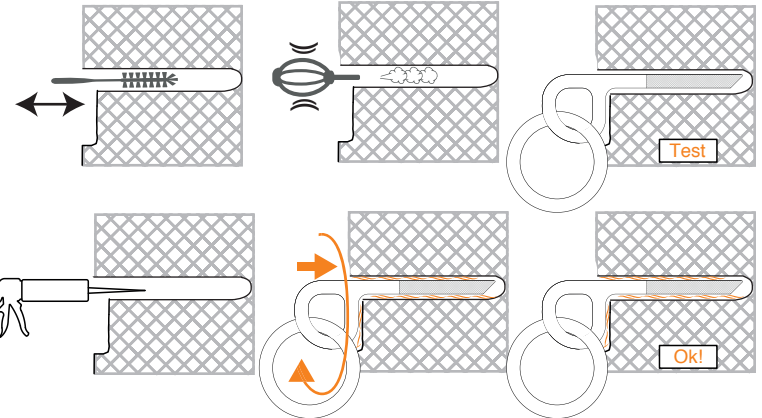
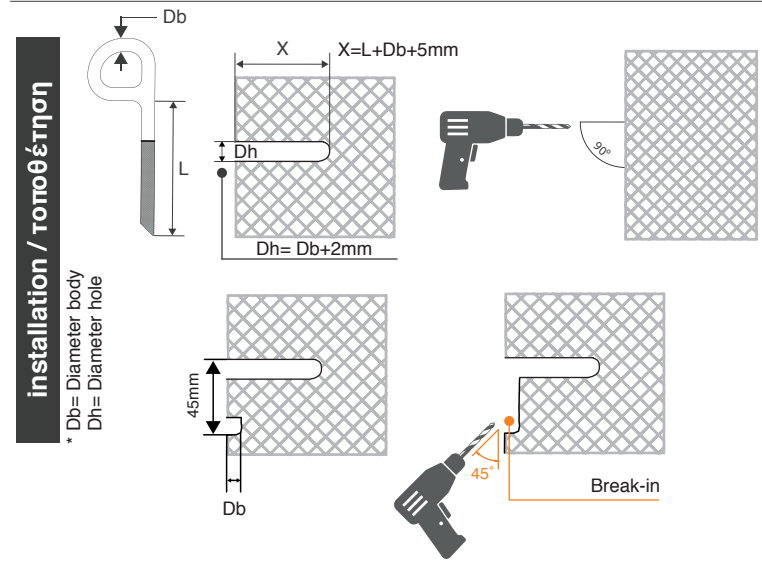

### APPROVED USE / ΟΡΘΗ ΧΡΗΣΗ

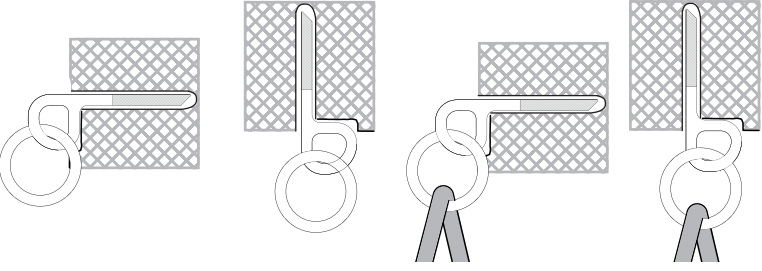

### WARNING / ΠΡΟΣΟΧΗ

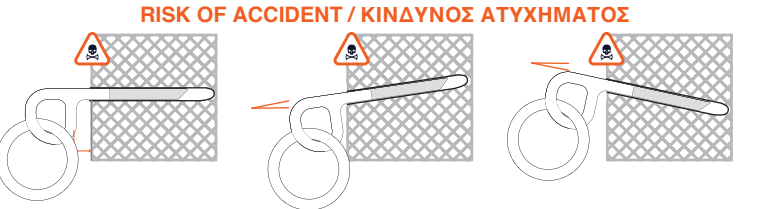

After the resin, do not touch the anchor and use it placed no earlier than 24 hours, even better if not least after 2/3 days (dependent on ambient temperature...). Still comply with the direction set by the factory of the resin used. The use of polyester type glue shall not be recommended.

Rock Anchor METEORA+ - Stainless Steel AISI 316L  
Χημικό Αγκύριο Ασφάλισης - Ανοξειδωτο Ατσάλι AISI 316L

user's manual / εγχειρίδιο χρήσης

certificates  
πιστοποιήσεις

EN 959:2018

UIAA123\_3

suitable for  
κατάλληλο για

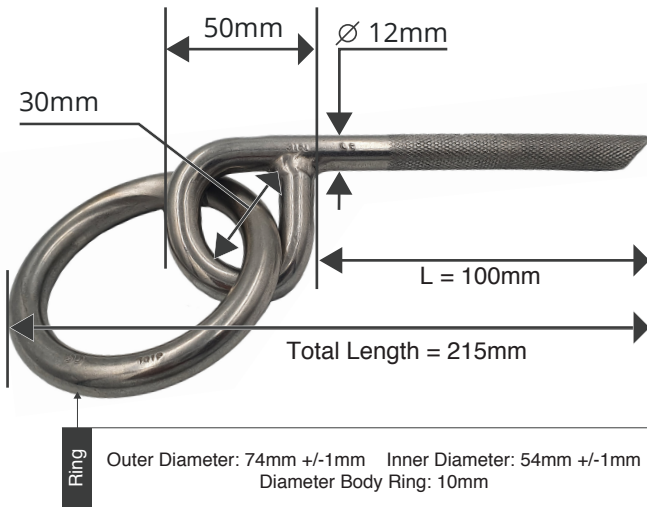

Weight / Βάρος = 316g

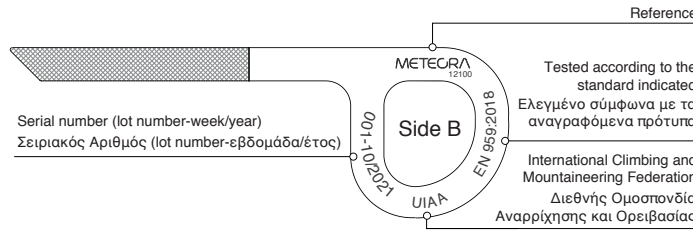
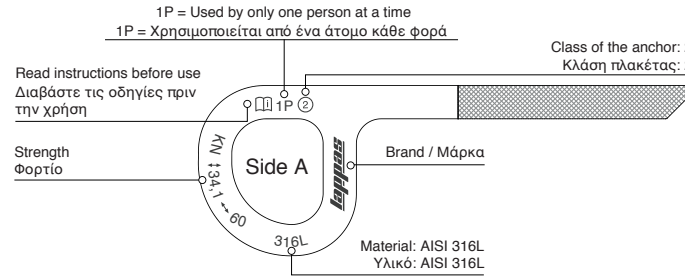

### resistance requirements - statics tests απαιτήσεις στατικής φόρτισης

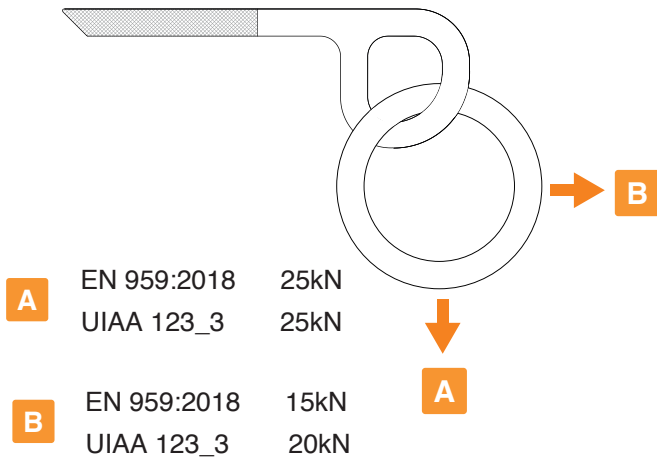

### effective strength / μέγιστη φόρτιση

A 60kN      B 34,1kN

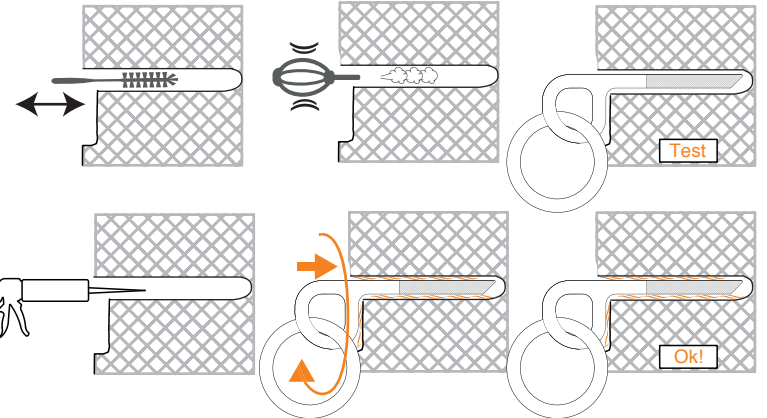
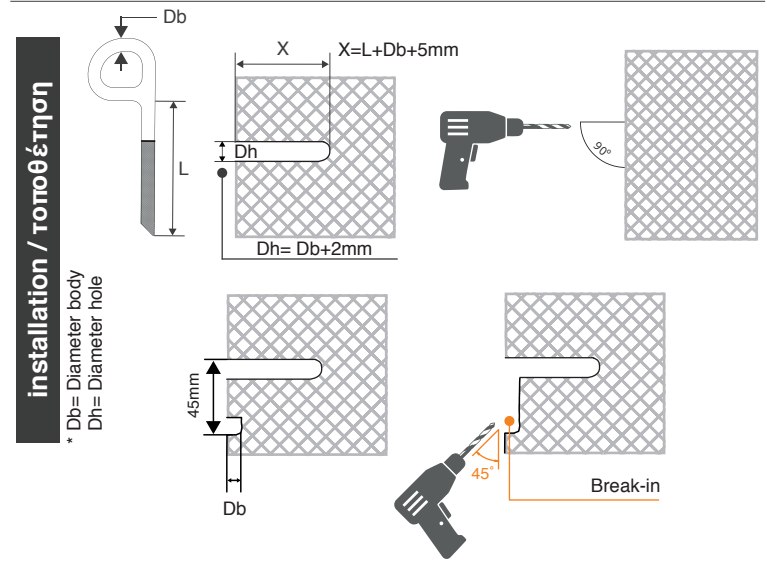

### APPROVED USE / ΟΡΘΗ ΧΡΗΣΗ

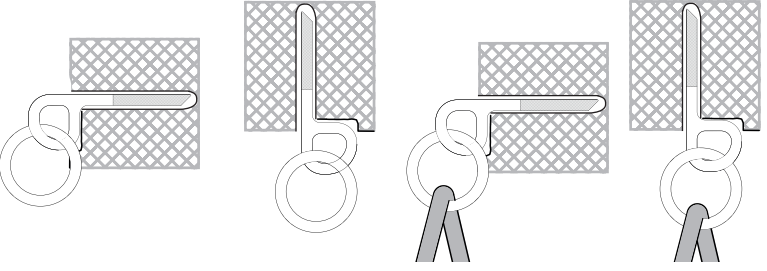

### WARNING / ΠΡΟΣΟΧΗ



After the resin, do not touch the anchor and use it placed no earlier than 24 hours, even better if not least after 2/3 days (dependent on ambient temperature...). Still comply with the direction set by the factory of the resin used. The use of polyester type glue shall not be recommended.